

AGENDA

TIME	CATEGORY	SUBJECT	PRESENTER
0930	Pre Brief	Reception and booking in	
1000	Introduction	Welcome	Col Matt Palmer Director Ten Tors
1010		Introduction to Ten Tors	Lt Col Tim Gilbert SO1 Ten Tors
1020		DNPA	Richard Drysdale & Simon Lee
1030		Devon and Somerset Fire & Recuse	Ian Donovan
1040	Pre Event	Administration	WO2 Avril Pino SO3 Ten Tors
1045		Training	Lt Col Tim Gilbert SO1 Ten Tors
1100		Moor Boots	Lt Col Tim Gilbert SO1 Ten Tors
1105		Environment Compliance Monitoring	ECM Lead Andy Hodges
1120		Clothing & Equipment	Chief Scrutineer Kevin Scott
1135		Registation	David Harris
1145		Q&A	
1200	Refreshments		
1220	The Event	Ten Tors Challenge	Lt Col Tim Gilbert SO1 Ten Tors
1230		Jubilee Challenge Plus	Lt Col Tim Gilbert SO1 Ten Tors
1240		Jubilee Challenge	Maj Paul McDougall
1250		Safeguarding	Lt Col Tim Gilbert SO1 Ten Tors
1255		Traffic Management	Maj Natalie Butler SO2 Ten Tors
1305		Awards	WO2 Avril Pino SO3 Ten Tors
1310		Engagement	WO2 Avril Pino SO3 Ten Tors
		Q&A	
1325	Close Col Matt Palmer		

HOUSE KEEPING

- Fire – exit, muster at the carpark
- Toilets - out of the hanger, turn right, walk up the hill, toilet block is on the right
- General questions:
 - Time permitting before the break
 - At the end of the briefings
 - Send questions to QR code (limited number)
- Team specific questions
 - After the TMB has concluded
- No gifted gear
- Refreshment break



241699



TEN TORS 26

TEAM MANAGERS' BRIEF

OPENING ADDRESS

COLONEL MATT PALMER – DIRECTOR TEN TORS

- **Welcome & Thank you**
- **Ten Tors 25 feedback and lessons**
- **Ten Tors 26**





INTRODUCTION TO TEN TORS

LT COL TIM GILBERT

S01 TEN TORS

TEN TORS 26

UK's largest outdoor youth engagement event

TEN TORS CHALLENGE

- Team event
- 3 Distances – set by age
- Saturday 0700 – Sunday 1700
- 'Without outside assistance'
- Limited to 400 teams

JUBILEE CHALLENGE

- Individual / Team event
- 4 Routes – selected by Establishment
- Saturday 0730 – 1800
- Supervised and assisted as required
- Limited to 450 participants

DARTMOOR GRANITE CHALLENGE

- Individual / Team event
- 1 route
- Saturday 0730 – Sunday 1100
- Supervised at all times
- Limited to 50 participants

TEN TORS OVERVIEW

WHO

2800 participants

2000 Team Staff

1000 enablers

6000 spectators

WHERE

Dartmoor Training Area

Duchy and other owners' land

Dartmoor National Park

Dartmoor Commons

WHEN

Training Oct – May

W/E post-May Day BH

8th – 10th May 2026

WHY

- Training benefit
 - Social responsibility
 - Engagement
- } MOD

SELECTION COMMITTEE – TTC

- **549 team** requests for 400 spaces
- Allocated **443** teams to 203 establishments
- Committee decisions:
 - Estb capped at 3 teams
 - Out of area estb:
 - 7 estb within criteria
 - Allocated 1 team each
- Ability to change distance on payment (no need to email TT).
 - Max 2 teams per distance ie 2 x 35, 1 x 45.
- Reserve team application window 1st-16th Jan 26 (email group mailbox)
- Reserve team priority for establishments with less than 3 teams
- Withdrawing teams: you will not be penalised, the sooner the better

SELECTION COMMITTEE – JC

- **676** participants applied from **58** establishments
- **509** participants allocated
- Distance allocation can be changed up until the event
- **450** cap for start
- **From 2027 all JC participants must have an EHCP**

SELECTION COMMITTEE – DGC (FORMALLY JC+)

- **46** JC+ participant requests from **11** establishments
- All allocated
- **50** participants cap
- **From 2027 all GC participants must have an EHCP**
- **Or case-by-case exceptional circumstances**



DARTMOOR NATIONAL PARK

RICHARD DRYSDALE & SIMON LEE

A wide-angle landscape photograph of Dartmoor National Park at sunset. The sky is filled with soft, orange and yellow light from the setting sun, with some darker clouds. The terrain is a mix of rolling hills, some covered in green grass and others in brown, dry heath. In the foreground, there are large, grey, craggy rocks. The overall mood is serene and majestic.

Welcome to Dartmoor National Park

RICHARD DRYSDALE –
DIRECTOR OF CONSERVATION AND COMMUNITIES



Ten Tors Team Managers' Presentation

Simon Lee Head Ranger





National Park Purposes

Dartmoor National Park Authority became an independent body within the local government structure on 1 April 1997.

Our role is clearly defined by Parliament in our two statutory purposes, which are to:

- conserve and enhance the natural beauty, wildlife and cultural heritage of the National Park;
- promote opportunities for the understanding and enjoyment of the special qualities of the area by the public.

In carrying out this work, we are also required to seek to foster the economic and social well-being of local communities within the National Park.



UK National Parks © Crown copyright.
All rights reserved. Dartmoor National
Park Authority 100024842 2011.

Dartmoor sunrise © Adrian Oakes

What makes Dartmoor special?

- In terms of its ecological and cultural heritage, Dartmoor is of **international importance** for its:

Southernmost blanket bogs in Europe



OVER 20,000 ARCHAEOLOGICAL SITES



Upland Heaths



Upland Oak woodlands





How can you help us conserve
and support this important
landscape and its communities.

Farming



PLEASE GIVE CATTLE SPACE!



Cows and their babies **HERE**



**Please stay at least
one bus length away
from mummy cows
and their babies.**

Give animals space
to keep them calm,
and help you
stay safe.



www.dartmoor.gov.uk



Cows and their babies **HERE**

Please stay at least
one bus length away
from mummy cows
and their babies.



Love Moor Life – Ranger code

Our Rangers care passionately about Dartmoor; it's a unique protected landscape with rare wildlife and free roaming livestock and ponies.



Keeps dogs under close control

Close & latch gates behind you



Bag up litter and take it home

Follow the camping code



Share the roads & bridleways

Don't feed the ponies



Important habitats for ground nesting birds



Protecting ground nesting birds

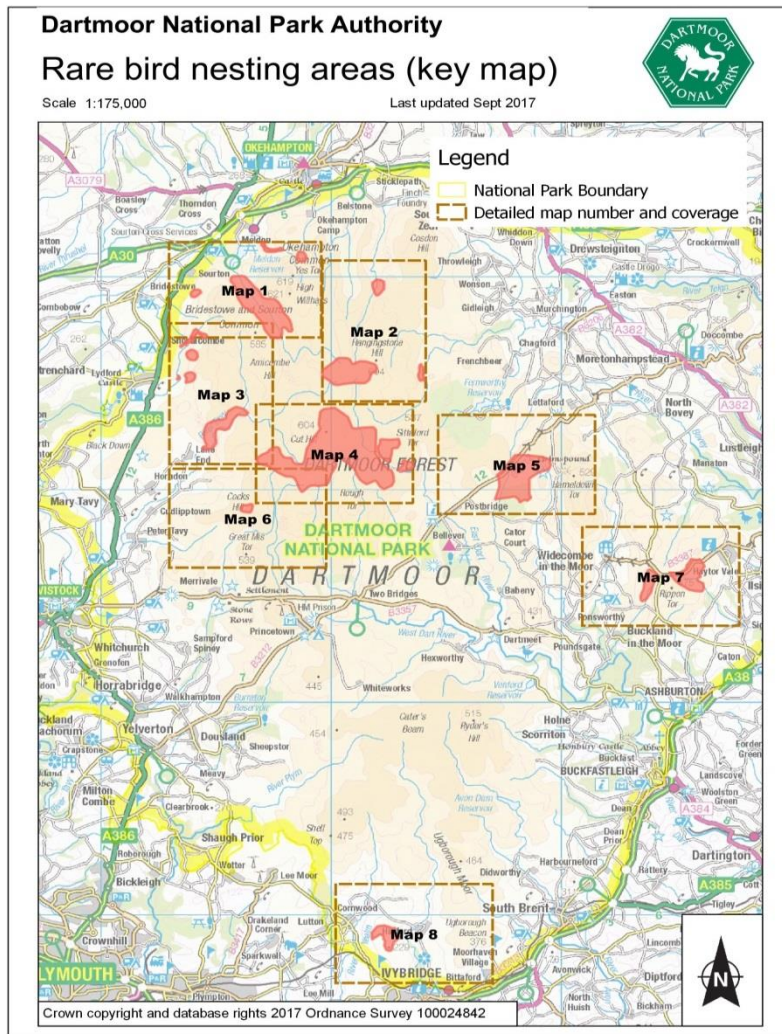

Transferring bird nesting areas onto maps

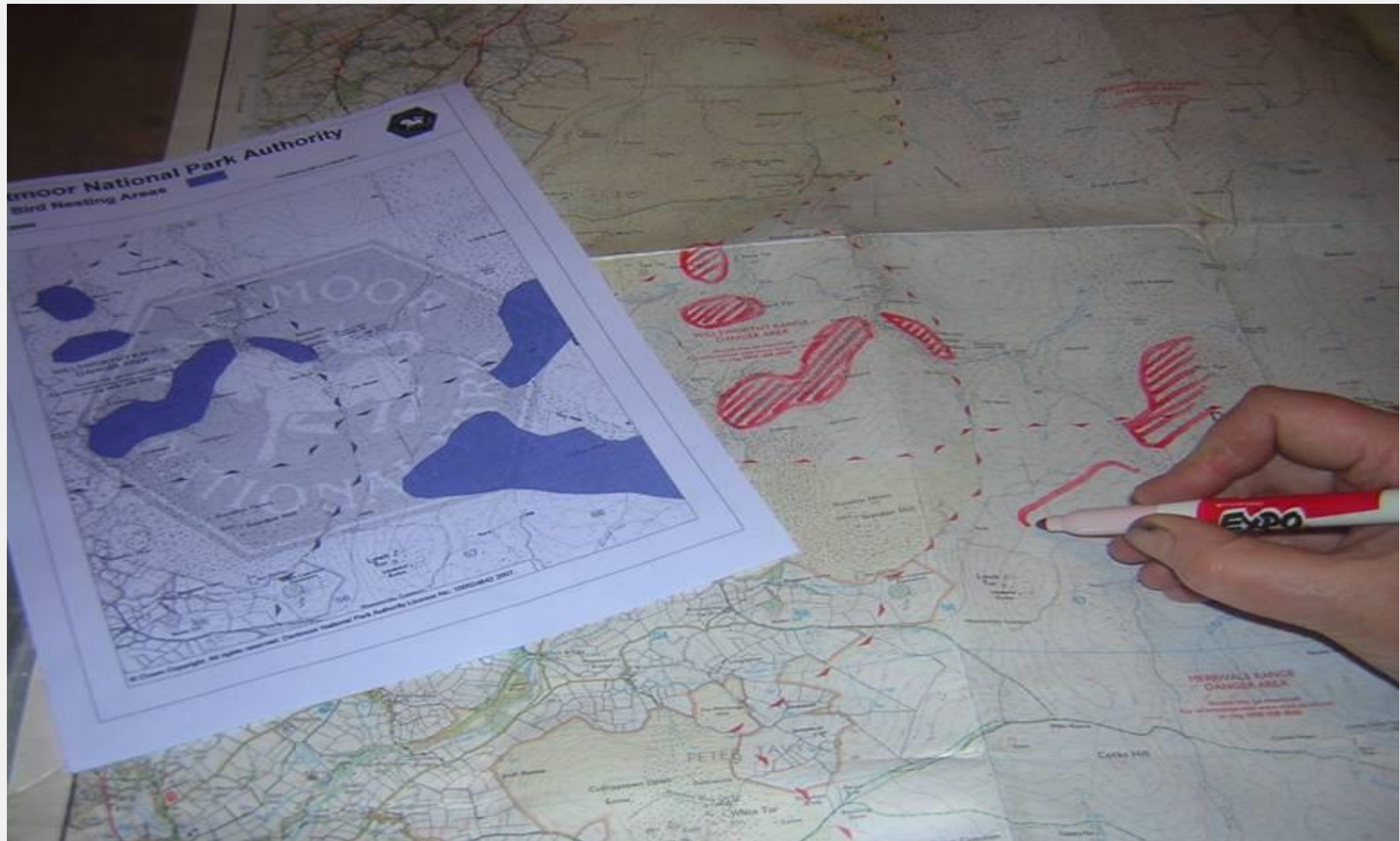

MANAGING EROSION AND THE TEMPTATION OF 'OPEN LANDSCAPE'



Donate for Dartmoor how does it work?



Recreational Dartmoor

There are 450 miles (730 kms) of footpaths and bridleways across the National Park. Your donation will help maintain these recreational routes through path repairs, new signage and improved access.

Repairing Nun's Cross Path
Relaunching the Two Moors Way
Replacing stiles with gates



Natural Dartmoor

Dartmoor provides a home for a range of wildlife, and is also an important stronghold for some declining and threatened species. Your donation will help look after important habitats.

Helping the House Martin
Conserving the Southern Damselfly
Last stand of the Mountain Blackbird



Historic Dartmoor

The archaeology of Dartmoor is very special and evidence of how people have lived, worked and died in this landscape for over 6,000 years can still be seen. Your donation will help conserve these amazing archaeological features.

Laser scanning of stone crosses
Bringing Dartmoor to the classroom
Preserving the future of the past

THANK YOU!

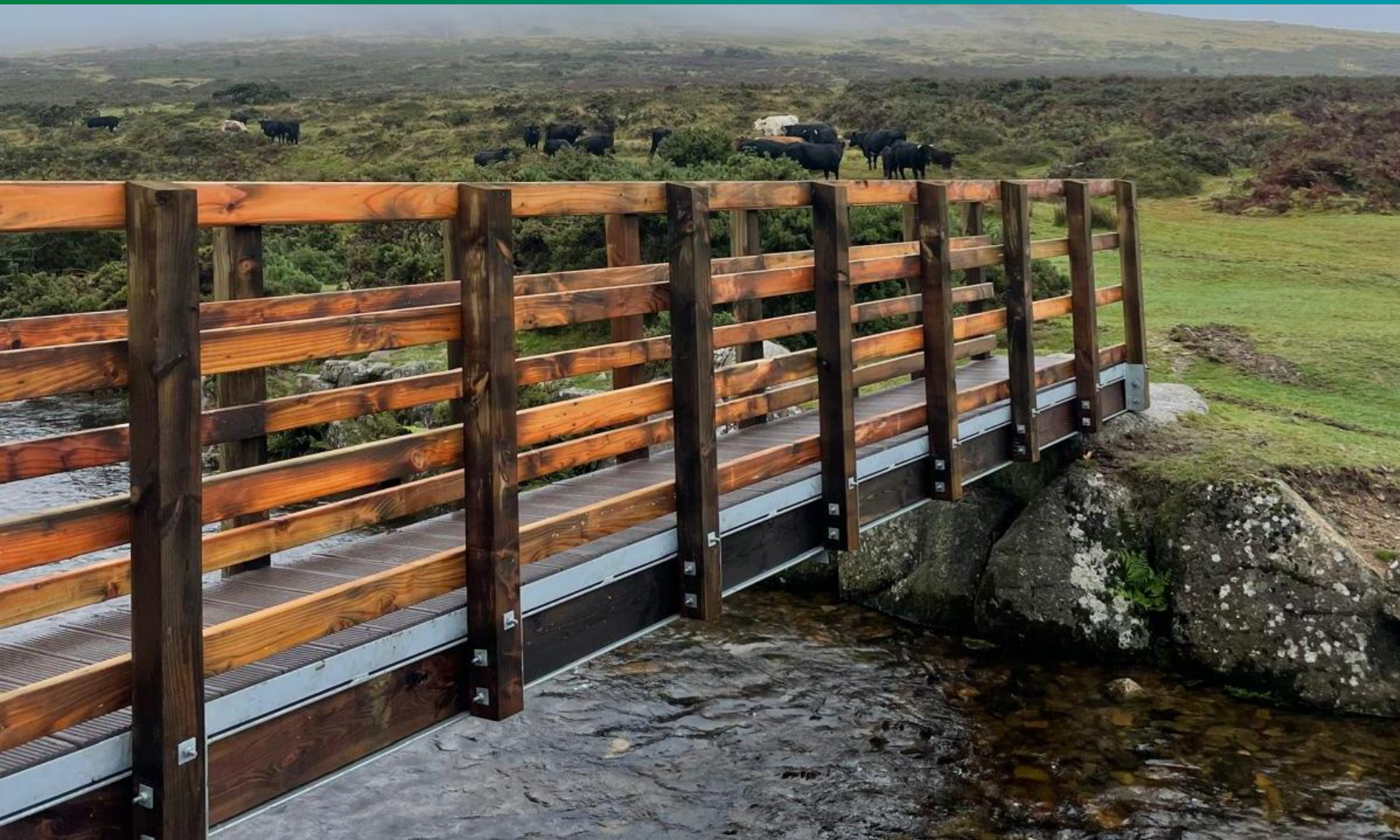



Bowerman's Nose © Thomas Dobner



DEVON & SOMERSET FIRE & RESCUE

IAN DONOVAN

A large fire is burning in a field of dry grass and shrubs. Thick, dark smoke rises from the fire, filling the left side of the frame and partially obscuring the sky. The fire itself is visible as a bright orange and yellow line across the middle ground. In the background, there are rolling hills under a clear blue sky with some light clouds.

TEN TORS 2026

Uncontrolled wildfires in sensitive areas like Dartmoor can cause long-lasting damage to wildlife and have a significant impact on the landscape. Wildfires also put livestock and members of the public at risk.

Wildfires are a serious problem for the fire service

Wildfires under the right conditions can be extremely dangerous with flame lengths exceeding 1.5 metres and fast moving. Wind speed, wind direction, humidity, temperature, all these variables have an impact in terms of wildfire.

Most are started by human actions such as: disposable barbecues discarded cigarettes and campfires.

What can we do to prevent wildfires?

We ask people not to use barbecues, to take extreme care when disposing of cigarettes and matches and to take all litter home when they leave. Great care should also be taken with camping stoves and fuel which are always best placed on flat stones wherever possible.



What to do if there is a fire

Keep calm. Call **999** and ask for the Fire and Rescue Service and give your exact location.

Providing a six-figure map reference or What3words.

Make sure you download the What3words app on your phone – this can help the fire service pinpoint your exact location in the event of a fire.

Distance yourself from the fire

Contact your Team leader (during training) explain the situation and where you are heading.

Team Leader to contact Fire Control on 03333990014 or 999 to confirm that the team are distancing themselves from the fire and heading towards.



PRE-EVENT ADMINISTRATION

WO2 AVRIL PINO
SO3 TEN TORS



PRE EVENT

ADMINISTRATION

- Ten Tors Team
 - SO1 Lt Col Tim Gilbert
 - SO2 Maj Nat Butler
 - SO3 WO2 Avril Pino
 - Commander's Advisor Peter Harper
- TMB Registration form – have you handed it in?
- Trackers – Safety Beacon
- Training on Dartmoor – NLT Wednesday before training weekend
- Website – main source of information
- Emails - swhq-tentors-mailbox@mod.gov.uk
 - Subject: 1111 Example School
- Payments – On time or you will forfeit your teams
- 'Where's to Quiz' – discontinued.
- Merchandise





TRAINING

LT COL TIM GILBERT
SO1 TEN TORS

TRAINING SCOPE

- Overview
- Training on Dartmoor
- Environmental Compliance Monitoring



2. Head of Establishment (HoE). The **HoE ... is responsible,** on behalf of the employer, **for the safety of their participants in training,** although this may be delegated to a designated Team Manager (completed online via TM Dashboard).

The **HoE must assure the Director Ten Tors** that all the team management are competent and suitable for the role to which they are assigned.

By sponsoring an entry the HoE accepts responsibility for all participants' behaviour in training ... this includes individuals who are not members of their own establishment.

HoE Assurance to be completed via the dashboard **before** you can start training.

3. Team Manager. The **TM**, appointed by the HoE, is responsible for all aspects of their Team's training.

With the agreement of the HoE, the TM may delegate training and other duties to competent and qualified Training Event Leaders, deputies and assistants.

*Prior to the start of a Challenge, the **TM** is required to assure the Director that all participants ... are sufficiently trained [and] physically prepared... to complete [their Challenge] unaided even in adverse conditions.*

22. [General] Requirement. *The Challenges are demanding expeditions. Thorough preparation and training are essential to complete the Challenges safely. The HoE is responsible, through their TM, for the conduct of training. The MOD accepts no responsibility for safety in training.*

24. Incidents. *The Ten Tors Secretary, or at weekends the Ten Tors Duty Officer, is to be informed **within 48 hours** of any incident in training that:*

- a. Involves the **emergency services**.*
- b. Results in **hospital treatment**.*
- c. May result in **media coverage**.*
- d. May lead to **complaint from a 3rd party**.*

16. Individual training requirement. *Before the Event participants must complete a structured and progressive programme of training which includes as a minimum:*

- a. Minimum of 4 days of training on Dartmoor.*
- b. 2 nights of wild camping on Dartmoor.*
- c. From 01 Feb no more than 4 days on North Moor*
- d. Experience of walking in an unsupervised group.*

17. Team training requirement. *In addition to the above, Teams must:*

- a. Be sufficiently trained, physically prepared and suitably equipped to enable the team to operate safely on their own and complete the Challenge unaided even in adverse conditions.*
- b. Train as a team on at least one expedition noting that best practice would be to conduct regular training as a defined team. **Last minute composite teams are not permitted.***

RULES – GREEN CARD TEAM MANAGER

TEN TORS 2025 - 26 GREEN CARD - STAFF GREEN CARD RULES FOR TRAINING ON DARTMOOR

These Rules must be followed by ALL those involved in training for Ten Tors and a copy must be carried by every walking group.

MOD, Ten Tors, and DNPA officials monitor training to ensure compliance.

Ignoring this Card may debar teams and establishments from the Event in this and future years.

Establishment Name & Code:

Training Event Leader's Name and Phone:

Off Moor Controller's (if applicable) Name & Phone:

Ten Tors Duty Officer (TTDO) – weekends 11 Oct to Event only: 07801 907 589

Headquarters Dartmoor Training Area (HQ DARTA) – all year: 01837 657 210

General

- The [Dartmoor National Park \(DNP\) Byelaws](#) are to be obeyed at all times.
- The TM is to ensure that the Ten Tors Secretary, or (if over a weekend from 11 Oct to the Event) the TTDO, is informed within 24 hours of any incident as detailed in the Rules.
- Establishment Codes are to be displayed on two A4 panels which are easily visible to ground observers.
- The Rules for Participants should be explained as part of an establishment's preparation phase training.

Planning

- TMs are to minimise the environmental impact of training, for instance by selecting locations other than the tops of tors as checkpoints or making maximum use of Public Rights of Way (PROWs) and existing paths. Consider training on areas other than Dartmoor.
- All maps must show Out Of Bounds (OOB) and rare bird nesting areas (RBNA) as detailed in the Annex A to the Rules.
- During the training period, other areas may be designated as OOB: ensure you check the Ten Tors website when planning training.
- Ensure groups only used permitted paths near Standon Farm during training.
- From 11 Oct 25 onwards:**
 - TMs are to inform the Organisers by 0800 Wednesday each week of training for the coming weekend using the TM's dashboard; this is to assist with training compliance and environmental monitoring. Although training is not checked or monitored for safety purposes a list of planned training is provided to the emergency services and Dartmoor National Park Authority (DNPA) to assist in the event of incident.
- From 1 Feb 26 onwards:**
 - Walking groups are limited within the North Moor (the area North of the Tavistock – Two Bridges – Moretonhampstead road and west of the 68 easting) to no more than 4 days training for a maximum of 12 + 2 adults per allocated team eg. establishments with 3 teams participating are not permitted more than 42 walkers.
- There is to be **no training** on Dartmoor over the Easter weekend (03 Apr – 06 Apr 26).
- Base camps are not permitted on the open moor. TMs must arrange for these to be located at established campsites or, with the landowner's permission, on private land. Details of landowners prepared to permit camping are on the [Enjoy Dartmoor](#), [Visit Dartmoor](#) and [Ten Tors](#) websites.

Vehicles

- Vehicles are to have the establishment's Code clearly displayed on the dashboard.
- All non-metalled roads (including the Okehampton Range Loop Road) are OOB to vehicles unless permission is given by the TTDO or HQ DARTA.
- Off-road driving is not permitted.

- Unless parking off the road with the permission of the landowner, only designated public car parks are to be used. Be considerate of others in public car parks and leave at least half of the area for public parking.
- Thoroughfares and gateways are not to be obstructed.
- The National Park Byelaws prohibit overnight sleeping in vehicles in car parks or on roadsides.

Understand property rights

- All of Dartmoor is owned by somebody.
- Enclosed land is not to be used without the permission of the landowner unless it is a PROW or Countryside and Right of Way public access land.
- Commons and Access Land, as shown on Annex A, may be used for walking.
- Backpack camping is only permitted in the areas shown on the [DNPA website](#).

Respect the Moor and its other users

- Tread lightly. Leave no trace. Give nature space.
- Engage with other walkers and farmers, who you meet.
- Do not enter OOB areas.
- If a track is worn do not walk alongside it as this will spread the erosion.
- Do not climb over walls or field boundaries - use gates, stiles or constructed gaps.
- Close gates irrespective of how you found them.
- Respect all ancient monuments and ruins.
- Do not disturb stones from moorland, dry stone walls or old buildings.
- Do not pollute or obstruct streams rivers & leats – they may be somebody's water supply.
- Take all litter home.
- Bury poo and toilet paper under at least 15cm of turf.
- Do not disrupt or cause a hazard to traffic.

Prevent wildfires

- Wildfires can be devastating; do not light open fires or take naked flames near flammable areas.
- Use cooking stoves carefully.
- Farmers are permitted to conduct controlled burning to manage vegetation between 1 Oct and 31 Mar; these types of fire will be under close supervision and over relatively small areas.
- Report all uncontrolled or suspicious fires to the Fire Service on 999 immediately.

Protect plants and animals

- Avoid disturbing plants, wildlife, and livestock.
- Rare Bird Nesting Areas (RBNAs) must not be entered during the period 1 Mar – 31 Jul except in emergency.
- Dogs must not be allowed to disturb animals.
- Do not feed or touch ponies or attract them to the road.
- Leave young or distressed animals alone.
- Report animals in distress or stray dogs to the Dartmoor Livestock Protection Officer on 07873 587561.

Camping

- Backpack camping locations are to be at least 100m from any building, road, or other backpack camping location and are to be within areas permitted on the [DNPA website](#).
- Do not backpack camp in sight of a road or building.
- Backpack camping locations used for Ten Tors training must not contain more than 14 people.
- Keep noise to a minimum when camping – remember that sound travels further by night.

Ranges

- The boundaries of the 3 Range Danger Areas are shown on maps and are marked on the ground by signs on red and white posts. When red flags or lights are displayed entry is forbidden. Guaranteed public access dates and 6 weeks' notice of firing are published on the [MOD website](#).
- Unexploded ordnance surfaces occasionally; it may be dangerous so **DO NOT TOUCH**. Mark the area and give a grid reference and description of the object to HQ DARTA.

TRAINING

RULES – GREEN CARD PARTICIPANTS

TEN TORS 2025 - 26 GREEN CARD - PARTICIPANTS GREEN CARD RULES FOR TRAINING ON DARTMOOR

These Rules must be followed by ALL those involved in training for Ten Tors and a copy must be carried by every walking group.

MOD, Ten Tors, and DNPA officials monitor training to ensure compliance.

Ignoring this Card may debar teams and establishments from the Event in this and future years.

Establishment Name:

Establishment code:

Training Event Leader's Name:

Training Event Leader's phone:

Off Moor Controller's (if applicable) Name:

Off Moor Controller's (if applicable) phone:

Ten Tors Duty Officer (TTDO) – weekends 11 Oct to Event only: 07801 907 589

Headquarters Dartmoor Training Area (HQ DARTA) – all year: 01837 657 210

General

- The [Dartmoor National Park \(DNP\) Byelaws](#) are to be obeyed at all times.
- Establishment Codes are to be displayed on two A4 panels which are easily visible to ground observers.
- The Rules for Participants should be explained as part of an establishment's preparation phase training.
- Two of these cards (Green Card) should be carried at all times by each walking group.

Understand property and access rights

- Unless on Access Land, Public Right Of Way (PROW) must be followed.
- Commons and Access Land, as shown on Annex A, may be used for walking.

Prevent wildfires

- Wildfires can be devastating; do not light open fires or take naked flames near flammable areas.
- Use cooking stoves carefully.
- Farmers are permitted to conduct controlled burning to manage vegetation between 1 Oct and 31 Mar; these types of fire will be under close supervision and over relatively small areas.
- Report all uncontrolled or suspicious fires to the Fire Service on 999 immediately.

Respect the Moor and its other users

- Tread lightly. Leave no trace. Give nature space.
- Engage with other walkers and farmers, who you meet.
- Do not enter Out Of Bounds (OOB) areas.
- If a track is worn do not walk alongside it as this will spread the erosion.
- Do not climb over walls or field boundaries - use gates, stiles or constructed gaps.
- Close gates irrespective of how you found them.
- Music players are **not** to be used at any time.
- Respect all ancient monuments and ruins.
- Do not disturb stones from moorland, dry stone walls or old buildings.
- Do not pollute or obstruct streams rivers & leats.
- Take all litter home.
- Be aware of and put into practice the 3P's for bathroom and human waste.

Protect plants and animals

- Avoid disturbing plants, wildlife, and livestock.
- Rare Bird Nesting Areas (RBNAs) must not be entered during the period 1 Mar – 31 Jul except in emergency. Maps must be marked from 1st February 2026.
- Do not feed or touch ponies or attract them to the road.
- Leave young or distressed animals alone.
- Report animals in distress or stray dogs to the Dartmoor Livestock Protection Officer on 07873 587561.

Camping

- Backpack camping locations are to be at least 100m from any building, road, or other backpack camping locations and are to be within areas permitted on the DNPA website.
- Do not backpack camp in sight of a road or building.
- Backpack camping locations used for Ten Tors training must not contain more than 14 people.
- Keep noise to a minimum when camping – remember that sound travels further by night.

Ranges

- The boundaries of the 3 Range Danger Areas are shown on maps and are marked on the ground by signs on red and white posts. When red flags or lights are displayed entry is forbidden. Guaranteed public access dates and 6 weeks' notice of firing are published on the MOD website.
- Unexploded ordnance surfaces occasionally; it may be dangerous so **DO NOT TOUCH**. Mark the area and give a grid reference and description of the object to HQ DARTA.

Environmental Control Monitors

- If you are stopped by an adult remember to ask them for their ID card. Only take advice from someone that shows you a Ten Tors ECM card.

In the case of an emergency:

- Stop. Make sure all the group are together.
- Follow your first aid training: DRS ABC
- Contact your Off Moor Controller or Training Leader and provide them with this information:
 - Who is injured.
 - What the injury is.
 - Your location – grid reference.
- Make yourselves visible.
- Use a whistle and/or torch to attract help.
- Keep a light on in your tent, this aids the rescuers in locating you.
- Listen for horns or whistles blowing and respond loudly.



MOOR BOOTS

LT COL TIM GILBERT
ON BEHALF OF TOM USHER

PRE EVENT

MOOR BOOTS

Moor Boots. Free kit for kids who simply can't afford it- enabling activity not added extra!

2025

- 76 grant recipients
- £8,500 of kit provided

2026- Process

- **Next week**
- Application flyer shared with TMs.
- Applications open Fri 10th via online form
- Pay and claim (mostly)
- Applications open until end of April



DARTMOOR
PRESERVATION
ASSOCIATION

Why?

- Our charitable objects
- Campaigning for equal access to Dartmoor

What we ask in return

- Quotes
- Shares on socials
- VLOGs
- Liaison with our comms team



ENVIRONMENTAL COMPLIANCE MONITORING

MR ANDY HODGES

LEAD ECM

WHY DO WE HAVE ENVIRONMENTAL COMPLIANCE MONITORS?



WHY DO WE HAVE TO COMPLY?

The Ten Tors Challenges only exist with the agreement and support of Dartmoor stakeholders.

The ECM team provide assurance that those venturing onto the moor under the guise of Ten Tors meet a set of standards, our rules.

Everyone should want to uphold this promise.

The Rules For Training (Green Card) should be common sense for regular moorland visitors.

WHY IS COMPLIANCE FALLING?

The last year saw the lowest level of compliance since monitoring began.

This is a serious concern as we must uphold our commitments to local stakeholders.

We have reviewed our reports and data from both the training phase and the event, and a few patterns seem to be clear.

COMMON EXCUSES

“We are doing this next week”

“It's our first time on the moor”

“We haven't covered this yet”.

“As a TM I don't get it, it's not difficult to be compliant unless you choose to ignore the advice, instructions and directives.”

A good Team Manager will have completed Care and Respect Training before going to Dartmoor.

NEW TEAM MANAGERS

The role of Team Manager is time consuming and onerous.
To learn the ins, outs and foibles of Ten Tors takes a couple of years.

We understand this, we walk that walk too.

**There is help out there, don't be afraid to ask for advice.
We want you and your teams to be successful.**

EXPERIENCED TEAM MANAGERS

Ten Tors changes each year.

Rules change.

Routes change.

RBNA areas change.

For experienced TMs to fall foul of the rules is disappointing.

Are TMs getting the information from the TMB ?

WHAT SHOULD A MEETING WITH AN ECM BE LIKE?

- An ECM should approach and identify themselves
- ECMs are likely to ask where the group has been and where it's heading.
 - ask to see maps with RBNAs correctly marked on them.
 - ask about Green Cards: are contents known?
 - check that the group is properly ID'd with Establishment numbers on two rucksacks
 - Green card is completed correctly and that the team know their emergency procedures.

WHAT SHOULD AN IDENTIFICATION PANEL LOOK LIKE?

A **minimum** of two identification panels are to be displayed at all times.



2025 COMPLIANCE DATA

- 31 ECMs covered all weekends from TMB to TTC
- We spent a total of 255 days out, up from 165, and 137 in 2024
- An average ECM day is 7-9 hours, most are part of an establishment's training team
- We met a total of 466 groups, up from 315, 309 in 2024
- 68% of groups were compliant, down from 85%, 86% in 2024
- 91 establishments did not meet minimum expectations, about 48% of all establishments.

EVENT HOT SPOTS

The majority of infringements were:

Steeperton Gorge downstream of Knack Mine Ford

Around Postbridge – road walking, Archerton, OOB
field crossings

**What are your teams experiencing during the
training phase in these areas ?**

CRITICAL INFORMATION TO TAKE AWAY

- Rules For Training On Dartmoor start **NOW**
- RBNA MUST be on maps from...**1st February**
- **Red** river sections are OOB throughout training
- Knowledge of the rules needs to be embedded **BEFORE** visiting Dartmoor
- **AT LEAST** two id panels at all times.
- **AT LEAST** two hi vis on all roads.
- **Regularly** check Firing Notices

All noncompliance is recorded and used in Selection

ESTABLISHMENT COMMUNICATION

- Are you clear on the changes you need to inform your training team about?
- When will you brief your training team on the new rules?
- Will you have a system in place to ensure your groups inform you of any noncompliance?
- When will RBNA be marked on maps?
- Have you got sufficient numbers of ID panels, Green Cards and hi vis?
- Do you have a system to check last minute Firing Notices changes?



CLOTHING & EQUIPMENT

KEVIN SCOTT
CHIEF SCRUTINEER



SCRUTINEERS

- 33 Scrutineers, with a further 2 provisional, drawn mainly from RN and RAF
- Dynamic Safety of the Event, as well as setting standards of equipment and clothing
- 604 years of TT Experience
- More than 1000 years of mountain experience
- Collective skills include, mountain and hill qualifications, Mountain Rescue Team, Paramedics, youth/adult training and mentoring, DBS, First Aid etc

To ensure the **SAFETY** of participants
and integrity of Ten Tors,
an audit of 10% of teams will be carried out,
on the Friday prior to the event,
to monitor compliance with ANNEX B.

The Clothing and Equipment List, Annex B, on the TT website is primarily developed with **SAFETY** of the **INDIVIDUAL** and **TEAM** in mind, irrespective of the weather conditions.

MANDATORY minimum (can have more).

Make sure they know how and when to use it.

Please takes notes and pass this info onto your participating Teams

*“Notwithstanding compliance with this list, the organisers **WILL** remove participants from a Challenge ... if they consider them to be unsuitably clothed or equipped to complete it in the forecast conditions, or if the TEAM or INDIVIDUAL is missing VITAL SAFETY related ITEMS from the list.”*



Extreme Lower Limit versus Comfort

Comfort rating indicates the temperature at which a cold sleeper might feel comfortable. This is the temperature rating brands use on women's bags.

Lower limit rating (which is always lower than the comfort rating) indicates the temperature at which a warm sleeper might still feel comfortable. This is the temperature rating brands use on men's bags.

ISO 23537 or EN13537 Compliant to -2 degrees C

Temperature ratings are estimates, not gospel

Although Sleeping Bags are generally tested to standards in a lab, it can't account for variations like differences in people's clothing and gear (i.e. sleeping pads), differences in body types (warm and cold sleepers), changing weather conditions, differences in food people eat and more.

You are responsible for ensuring your participants are comfortable throughout the training and Event. If in doubt advise your participants to obtain a sleeping bag that exceed the limit not meets it.

TROUSERS

- Trousers – wind resistant and quick drying
- In the last few years, changes have been made to the kit list to try and reduce the likelihood of **Tick Bites** and the potential to contract Lyme Disease and Tick-borne Encephalitis (TBE).
- Therefore, shorts and gym/yoga leggings are **PROHIBITED** from the Ten Tors Event.

GOV.UK - [UK Health Security Agency](#)

Tick-borne disease in the UK: stay safe this spring and summer

Posted by: [Blog Editor](#), Posted on: 13 April 2022 - Categories: [Health Protection](#)



As we head into spring and summer we are reminding people to be 'tick aware' as they enjoy the great outdoors.

Ticks can carry infections and while [Lyme disease](#) is more common in the UK, we have recently confirmed a case of tick-borne encephalitis (TBE) in England.

CLOTHING & EQUIPMENT

HEALTH

GOV.UK - [UK Health Security Agency](#)

Tick-borne disease in the UK: stay safe this spring and summer

Posted by: [Blog Editor](#), Posted on: 13 April 2022 - Categories: [Health](#)

**ACCORDING TO
NUMEROUS SOURCES,
IT'S GETTING WORSE!!**



... reminding people to be 'tick aware' as they
... [Lyme disease](#) is more common in the UK, we have
... tick-borne encephalitis (TBE) in England.

CLOTHING & EQUIPMENT

WATER & WATER STERILIZATION

Water Container Recommend: Platypus-type with a separate hard bottle provides an effective system. Total capacity **2 litres minimum**



WATER & WATER STERILIZATION

- Water Management
 - Two containers ensure sterilisation can be carried out while drinking supply maintained.
 - Ensure participants understand timing and doses of sterilization system used.
 - Annex B still applies to water management systems using non-chemical sterilizing methods.
- Participants will start with 2 litres of water.
Recommended at least one litre in each container.
- Ensure individuals hydrated pre-Event start, during Event and Post Event

Boots – with ankle protection and in good condition



- Rations – Arrange into meals.
 - Participants will have higher than normal calorie consumption, they **must** eat.
 - Calories equals energy which equals body heat.
- Emergency Rations – high energy & sealed.
 - Must be able to be consumed without processing e.g. adding water, or heating up

CLOTHING & EQUIPMENT

STATIC THERMAL LAYER

- Softshell
- Thick Fleece
- Primaloft
- Hydroloft
- Down



Know when to use it.

CLOTHING & EQUIPMENT

PERSONAL

- Intermediate Layer – Micro-fleece, sweatshirt etc
- Socks Pair – Thick walking type
- Waterproof Clothing – When to use it/When NOT to use it
- Whistle – Know its use

- Survival Bag – Know its use
- Personal Medication – Ensure other Team members are aware of use and location, if required
- Rucksack – Robust rucksack liner

CLOTHING & EQUIPMENT

TEAM

- TT25 Map with Bird Nesting areas and Out of Bounds
- Compass – Lightweight Compass with min 10cm baseplate
- High Viz Surcoats – knowledge how to use them on roads



Key points

10% Audit before event

Teams not complying with Annex B will be removed from event

The kit list is Mandatory and the Minimum

No shorts and gym/yoga leggings

Make sure they know how to get the best from their kit



JCSYS

MR DAVID HARRIS

David.harris@jcsys.co.uk

07506 729924



JCSYS

- JCSys support Ten Tors through:
 - Safety Beacon with the teams on moor
 - Website in the cloud
 - Management Information System (MIS)
 - Points of presence
 - Highlight the importance of correct data in the MIS
- Tracking
- Website (for pre-registration)
- Management Information System
- Ongoing streamlining of Registration
 - Printing own control cards and wristband inserts
 - Self Help system at Registration
- Key Dates

JCSYS

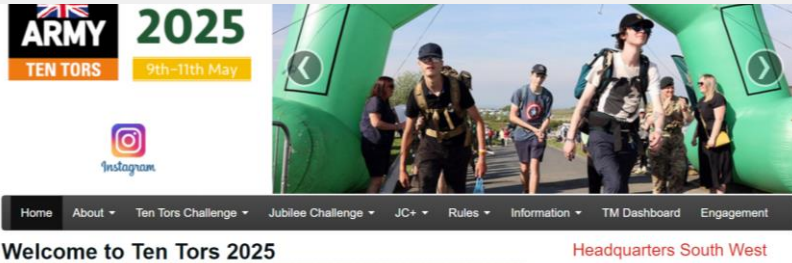

Website

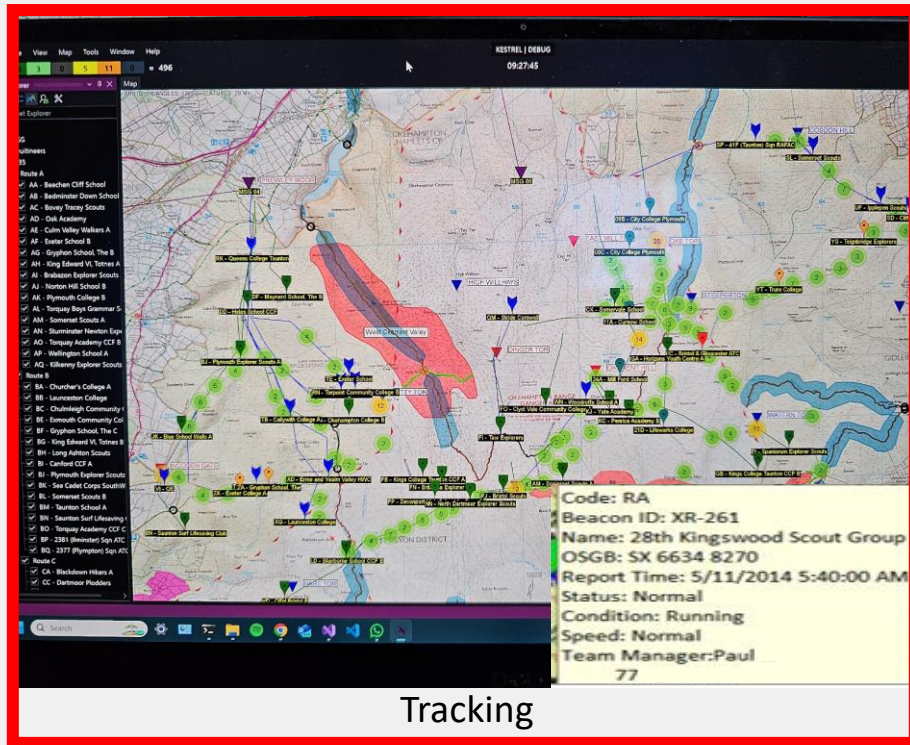

Tracking

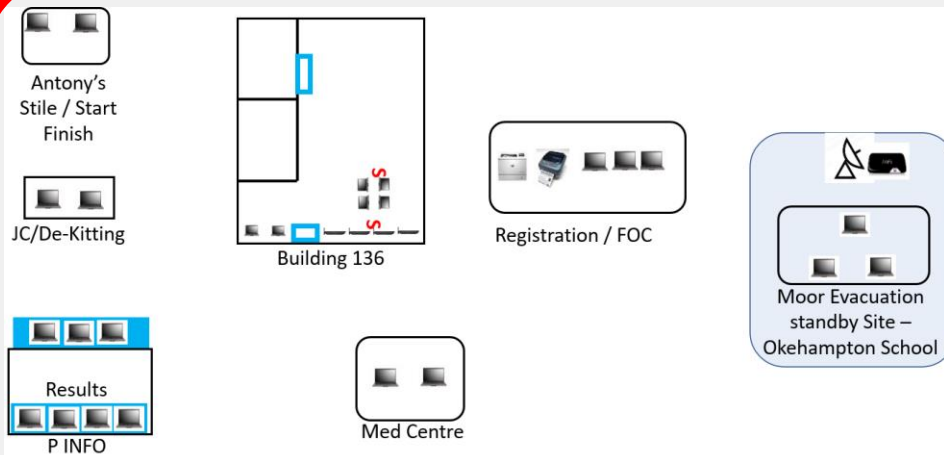

Management Information System



TRACKINGS

JCSYS

- GPS Location
- 2-Way Communicates via Iridium Satellite
 - Worldwide
- Emergency Button
 - Sets off visual and audio alarms in Ops Room
- 2 Way Text Function
 - River States
 - Cancel Event
 - Group or Individual Instructions
- Team Tracks NOT published until after the event

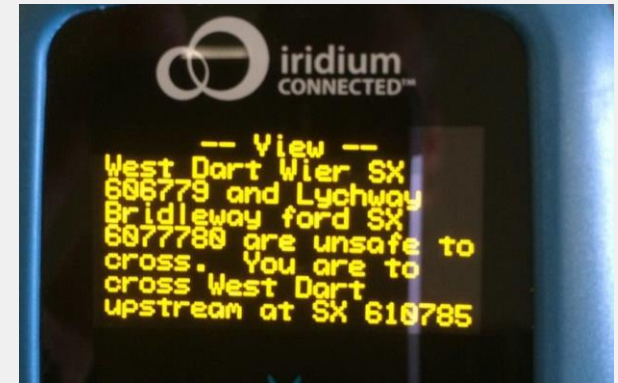

TRACKING

File View Map Tools Window Help

76 3 0 5 11 0 = 496

Explorer

Asset Explorer

IC

MSG

Scrutineers

TT35

Route A

- ☒ AA - Beechen Cliff School
- ☒ AB - Bedminster Down School
- ☒ AC - Bovey Tracey Scouts
- ☒ AD - Oak Academy
- ☒ AE - Culm Valley Walkers A
- ☒ AF - Exeter School B
- ☒ AG - Gryphon School, The B
- ☒ AH - King Edward VI, Totnes A
- ☒ AI - Brabazon Explorer Scouts
- ☒ AJ - Norton Hill School B
- ☒ AK - Plymouth College B
- ☒ AL - Torquay Boys Grammar S
- ☒ AM - Somerset Scouts A
- ☒ AN - Sturminster Newton Expi
- ☒ AO - Torquay Academy CCF B
- ☒ AP - Wellington School A
- ☒ AQ - Kilkenny Explorer Scouts

Route B

- ☒ BA - Churcher's College A
- ☒ BB - Launceston College
- ☒ BC - Chulmleigh Community C
- ☒ BE - Exmouth Community Col
- ☒ BF - Gryphon School, The C
- ☒ BG - King Edward VI, Totnes B
- ☒ BH - Long Ashton Scouts
- ☒ BI - Canford CCF A
- ☒ BJ - Plymouth Explorer Scouts
- ☒ BK - Sea Cadet Corps SouthW
- ☒ BL - Somerset Scouts B
- ☒ BM - Taunton School A
- ☒ BN - Saunton Surf Lifesaving C
- ☒ BO - Torquay Academy CCF C
- ☒ BP - 2381 (Ilminster) Sqn ATC
- ☒ BQ - 2377 (Plympton) Sqn ATC

Route C

- ☒ CA - Blackdown Hikers A
- ☒ CC - Dartmoor Plodders

KESTREL | DEBUG

09:27:45

Map

EPS: 10 TRIANGLES: 72587 TEXTURES: 29 Mb

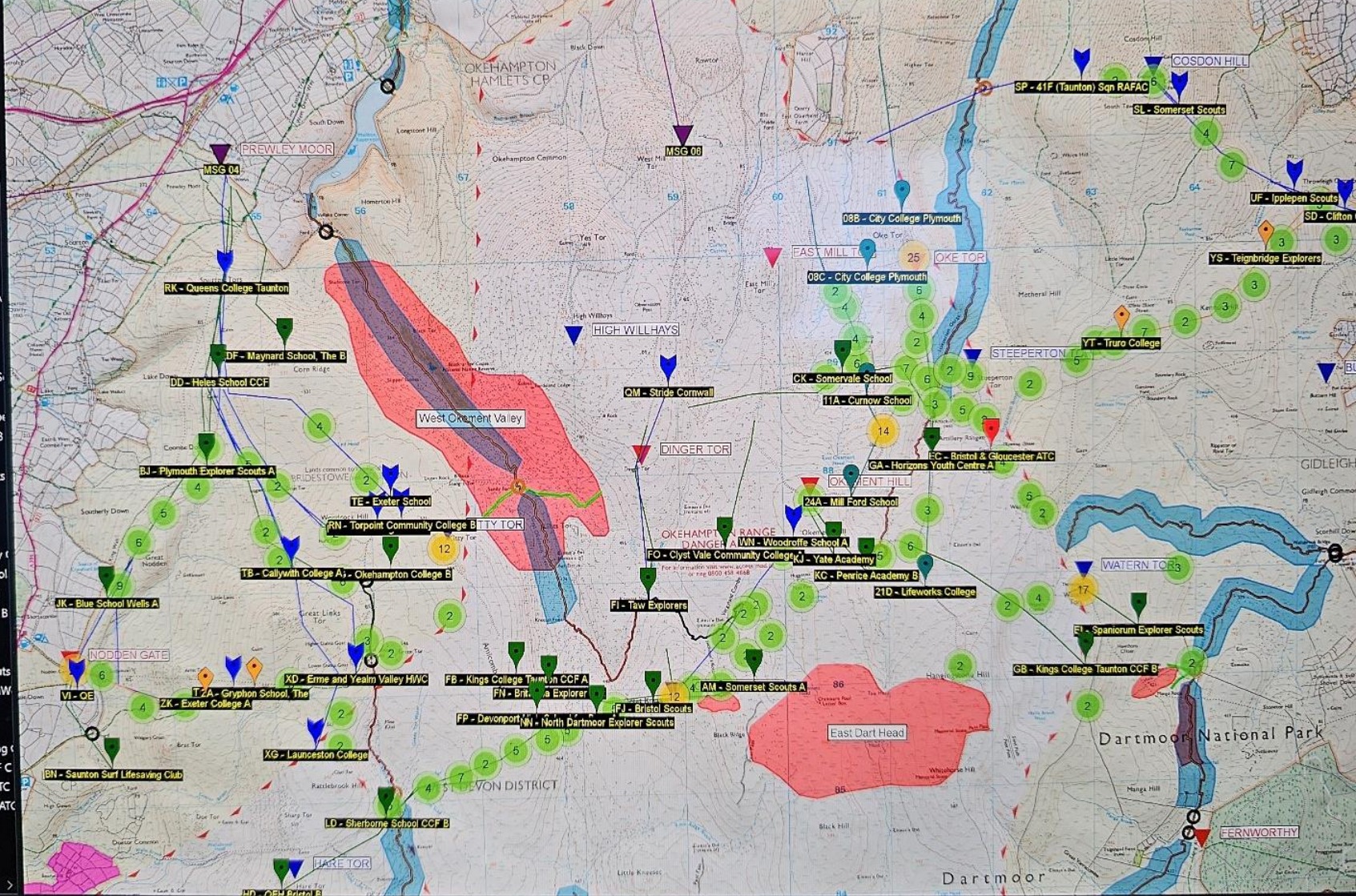

1:27391 313 m

Search

- 2023/4/5 Teams were not familiar with Safety Beacon operation
 - Spurious Emergency call as opposed to manual position location
 - Many beacons handed in “Beeping” hence unread message
 - Poor location of beacon
- 2025 first 25 teams checked failed a simple 6 point test
- Swapped testing for training
- 2026 Changed procedure for beacon issue



Welcome to Ten Tors 2026

Welcome to the Ten Tors 2026 web site. You can look back on Ten Tors 2025 and previous years [in the archive](#).

TT Secretary's Notices

Tue 23 Sep 2025 — ROAD CLOSURE AND ACCESS TO OKEHAMPTON

Please be aware that Okehampton will have significant roadworks taking place on the same weekend as the Team Managers' Brief.

- The eastern approach (Exeter Road) into Okehampton from the A30, shortly after Bearton Road, will be closed.
- Access from the east into the town centre will not be possible.

Recommended Route:

All traffic should remain on the A30 and use the Sourton slip road, entering Okehampton from the west. This will avoid delays and diversions caused by the closure.

Mon 1 Sep 2025 — Ten Tors 26 Entries Open

Team Manager entries for Ten Tors 26 are now open and will remain so until 1800 on 22nd September. Please ensure that all sections display a green tick. The Selection Committee will meet on 25th September, with results published on 29th September.

Headquarters South West Event Director



[Ten Tors 2025 Safeguarding Policy](#)

[Ten Tors 25 Event Guide](#)

Photos:

[Ten Tors Challenge 2025 event photos](#)

[Ten Tors Awards 2025 photos](#)

Please contact [photo-fit.com](#) directly with any queries about 2025 coverage and any previous Ten Tors editions since 2015.



Dashboard

[Dashboard](#) · [Log out](#)

Welcome back, David.

Entry Submission

The list below shows the sections needing to be completed. A tick means the section has been completed, while a cross means the section awaits completion. If anything has changed since your establishment entered, please add or amend the information.

- X [Manager details](#)
- X [Establishment details](#)
- ✓ [Team requests \(no longer applicable\)](#)
- X [Team Staff details](#)
- X [TM Assurances](#)
- X [HoE Assurances](#)

Training

Your recent training entries.

Date	Type	Participants
No training entries		
+ Add new		View all
All Estbs		

Ten Tors Award Applications

Applications will be open from January 6th to April 1st.



MANAGEMENT INFORMATION SYSTEM

JCSYS

MIS

Search...

Dashboard

Event: All

Logged in as: JCSys

Logout

⚠ WARNING: This is a live system. Please do not use for testing or training purposes.

Teams

ID	Route	Name	Status
ZF	TT 55	Taunton School	Finished
ZA	TT 55	Gordano District Scouts	Finished
ZE	TT 55	South Dartmoor CC	Finished
YR	TT 55	Stonar Explorer Scouts	Finished
XH	TT 55	Weston College	Retired
XC	TT 55	QEH Bristol	Finished
YQ	TT 55	QE	Retired
XV	TT 55	Beechen Cliff School	Finished
XW	TT 55	Camborne Science & Int Academy	Finished
YO	TT 55	Gryphon School, The	Finished
YI	TT 55	41F (Taunton) Sqn RAFAC	Finished
YU	TT 55	Truro School	Finished
XF	TT 55	Tavistock & Dist Youth Forum	Finished
XB	TT 55	Okehampton College	Finished
ZY	TT 55	Colyton Grammar School	Finished

Status Counts

Teams	TT	JC+	JC
Allocated	0	0	0
Registered	0	0	0
Started	439	6	77
Normal	0	0	0
Camped	0	0	0
Retired	31	0	0
Finished	408	6	77
Individuals	TT	JC+	JC
Started	2634	18	399
Awaiting Transit	0	0	0
In Transit	0	0	0
FOC	0	0	0
FATC	0	0	0
RTM	2634	18	399
Hospital	0	0	0

Tor Extraction List

--

MANAGEMENT INFORMATION SYSTEM

JCSYS

MIS

Search...

Teams / YQ - QE

Logged in as: JCSys Logout

⚠ WARNING: This is a live system. Please do not use for testing or training purposes.

YQ - QE

Team Details

YQ

Event: Ten Tors

Route: [Y \(55 miles\)](#)

Beacon: XR-479

Notes: Team to be withdrawn at Holming Beam. DRG will engage and direct team toward this location as it is not on their route. DRG have engaged and walking them to Holming Beam ETA 1230. Helicopter extraction.

Team Members

Event ID	Name	Status
YQ1		With Manager
YQ2		With Manager
YQ3		With Manager
YQ4		With Manager
YQ5		With Manager
YQ6		With Manager

Team Staff

	Name	Phone
TM	Mr. Keith Baker	
DTM	Colin Clark	
DTM2		
DTM3		

Timeline

MAY 05 14:01

Allocated

MAY 09 11:58

Registered

MAY 10 07:00

Normal

MAY 11 12:25

Retired
Directed
Retirement

Infringements

#	Type	Occurred At
---	------	-------------

Virtual Route Card

	START		07:00
via	HIGHER TOR [SC]		07:41
1	SHILSTONE TOR [SC]		09:10
2	KES TOR [SC]		10:29
3	POSTBRIDGE [SC]		13:10
4	HOLMING BEAM [SC]		15:40
via	WHITE TOR [SC]		17:28
5	WILLSWORTHY [SC]		19:10
via	NODDEN GATE [SC]		20:40
6	KITTY TOR		06:50
7	STANDON FARM [SC]		08:41
via	ROUGH TOR		
8	POSTBRIDGE [SC]		
9	SITTAFFORD TOR		
via	OKE TOR [SC]		
10	DINGER TOR [SC]		
	FINISH		

MANAGEMENT INFORMATION SYSTEM

JCSYS

MIS

Search...

Participants / [redacted]

Logged in as: JCSys [Logout](#)

⚠ WARNING: This is a live system. Please do not use for testing or training purposes.

KH3 - [redacted]

Participant Details

* Event ID

KH3

* Firstname

[redacted]

* Lastname

[redacted]

Date of Birth

01-01-2010

* Gender

Male

Notes

Call through to MSG Ops requesting authority for KH3 to be released to hospital (while in back of St. John's ambulance for ankle injury). Sent to TT Ops, verbally okayed. Call back to confirm release.
Contacted by FOC. Team manager on way to hospital

Private Notes

Cancel

Save

Timeline

MAY 05 14:01

With Team

MAY 10 20:24

Awaiting Transit
Medical Retirement at: SX 5921 7636

MAY 10 20:33

In Transit
SJA Ambulance

MAY 10 21:59

At Facility
Hospital - Derriford

MAY 10 23:58

With Manager

Team

Event ID	Route Type	Name	Status
[redacted]	[redacted]	[redacted]	Finished

Team Staff

	Name	Phone
TM	[redacted]	[redacted]
DTM	[redacted]	[redacted]
DTM2	[redacted]	[redacted]
DTM3	[redacted]	[redacted]

Casualties

Serial	Timestamp	Injury
CAS-013	10/05 22:22	MSKL - Suspected Broken Ankle



ARMY
TEN TORS

MIS POINTS OF PRESENCE

JCSYS

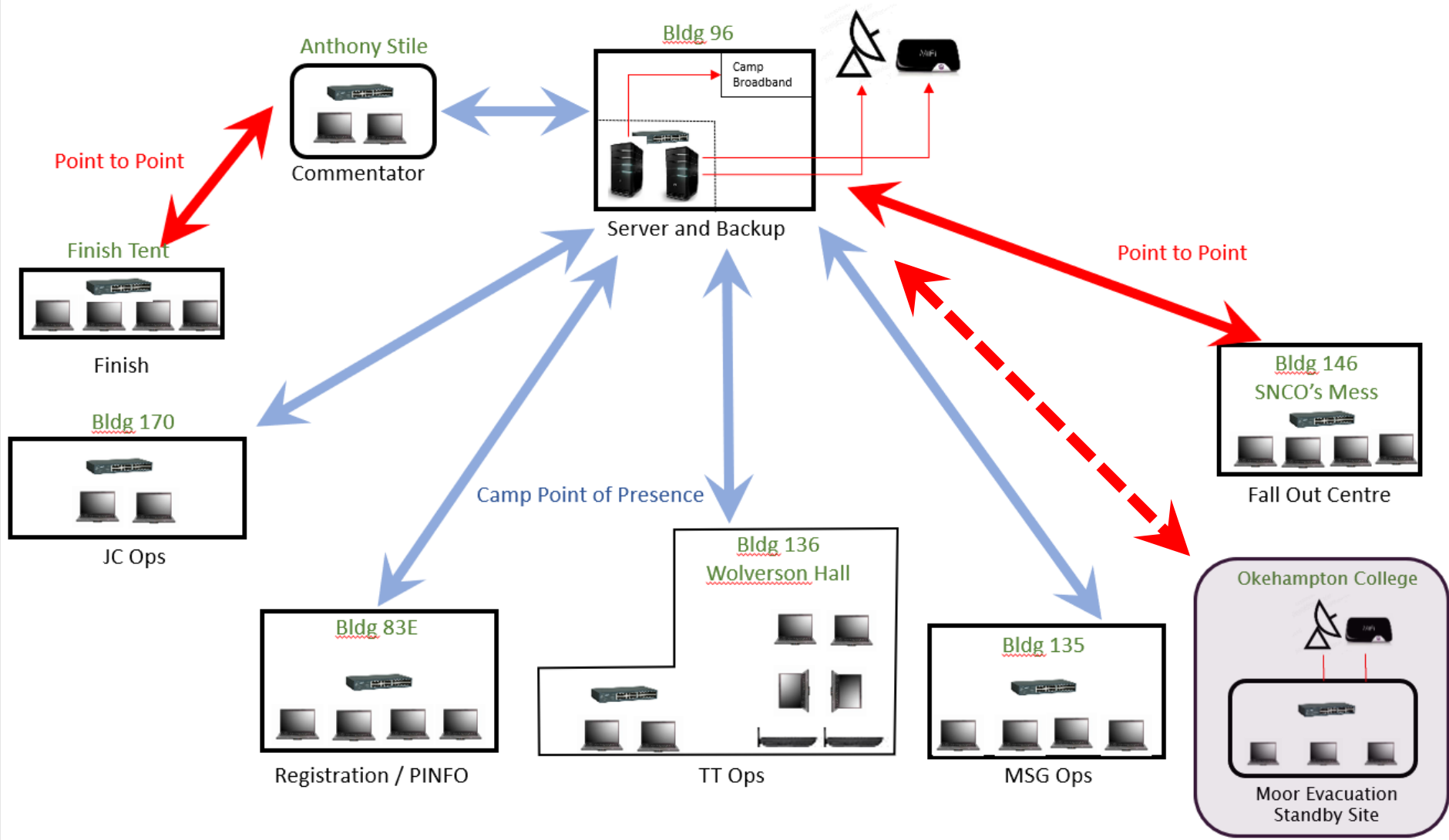

Continuing The Online Process

Documents and briefs to be accessed via the website:

- Safety Brief (inc Safety Beacon Brief)
- Tent Panel (for 35 Mile TTC only)
- TMs' Certificate (electronically signed)
- Control Card
- Wristband Insert

Documents to be printed out by TMs

	TTC	JC	GC	
Item				
Tent Panel (35 mile only)	√			
Control Card	√	√	√	Available from Tue 06 May 2025 at 0900 hrs
Wristband Insert	√	√	√	Available from Tue 06 May 2025 at 0900 hrs

Venue will be signposted. On Arrival:

- Handover completed tent location form
- Collect replacement map (if required)
- Confirm MIS team(s) details'
- Self help area for change with laptops and MIS access.
 - Registration and JCSys staff will be on hand to help
- **Safety Beacon Issue:**
 - **TTC: Team member to receive face to face tracker/safety beacon brief**
 - **JC: Issued to TM**
- **Only when the safety beacon is issued are the team registered and can start TT**

Notes:

- If no team member available, the TMs can do the first 4 steps and send a team member to collect later
- Registration will be open till 1700 on Friday and at 0600 on Saturday AM

REGISTRATION

JCSYS

- 1 Reception & Campsite Map collection
- 2 Map, wristband issue
- 3 TM self-service area
- 4 Tracker Issue
- JCSys Terminal
- G6 Terminal

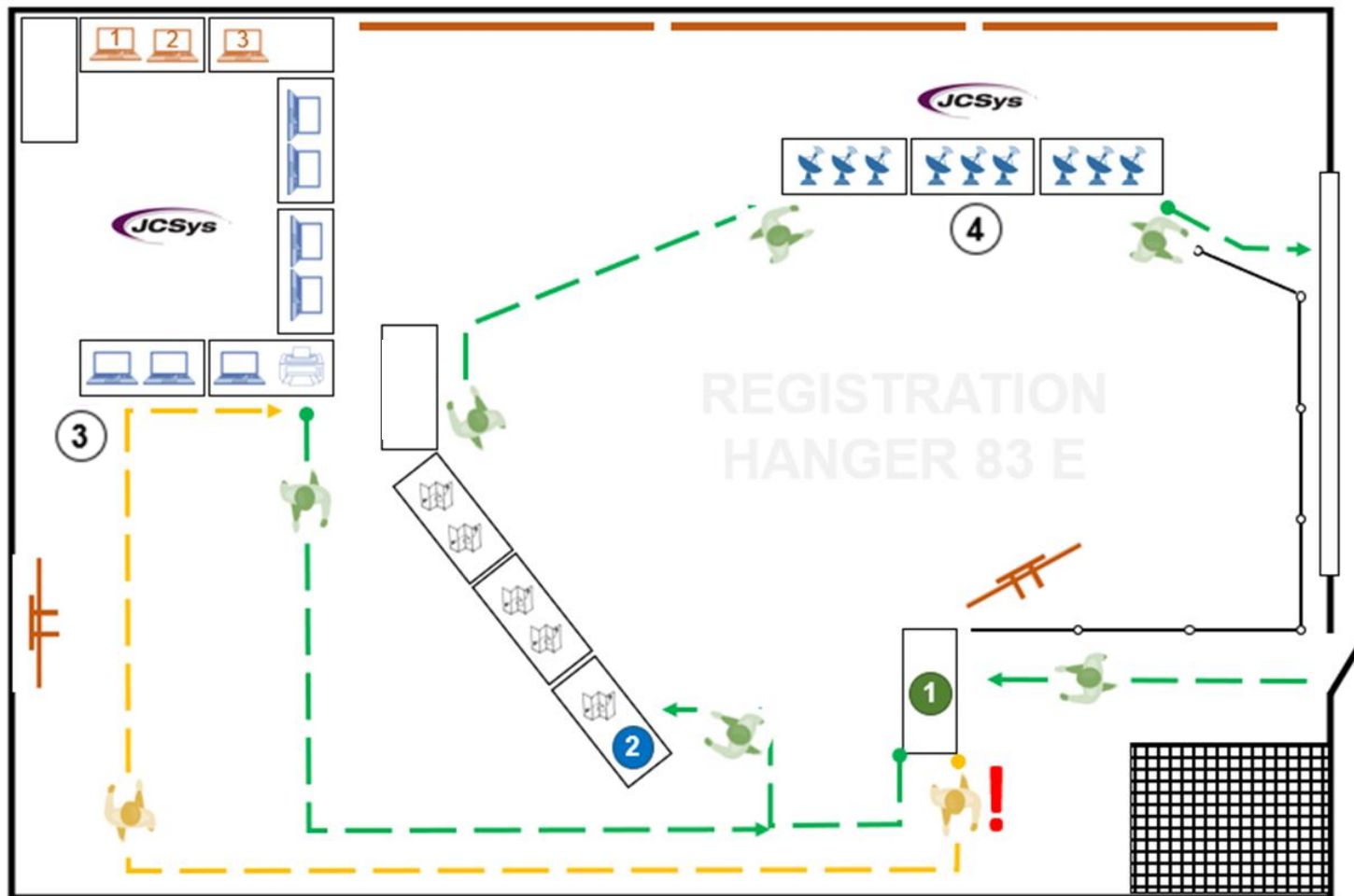

KEY DATES

JCSYS

Entries Submitted, via Team Mangers Dashboard	01 Sep 2025 to 1800 on 22 Sep 2025
Selection committee results published, on website	Mon 29 Sept 2025
Team Managers' Briefing, Okehampton Camp	Sat 04 Oct 2025
Payments, via Team Managers Dashboard	05 Jan 2025 to 1800 hrs Fri 30 Jan 2026
Pre-Registration, via Team Managers Dashboard	01 Apr 2026 to 2200 hrs Thu 07 May 2026
Routes published on website	Tue 05 May 2026 at 0900 hrs
Ten Tors Event, Okehampton Camp	Fri 08 May 2026 to Sun 10 May 2026

Notes:

- TMs will be able to change their entry and reprint their control cards and wristband inserts until pre-registration closes 2000 hrs Thursday D-2
- Changes after this time can be sent to SWHQ-TenTors-MAILBOX@mod.gov.uk (info david.harris@jcsys.co.uk) so that they can be actioned before Registration opens on D-1





QUESTIONS

PLEASE KEEP QUESTIONS RELEVANT TO WHAT HAS BEEN PRESENTED SO FAR



241699



REFRESHMENTS

SAUSAGE OR VEGAN SAUSAGE ROLLS, TEA & COFFEE

HANGAR NEXT DOOR

TOILETS – OUT OF THE HANGAR TURN RIGHT, WALK UP THE HILL, ON THE RIGHT

RETURN NO LATER THAN 1220 HRS PLEASE



THE EVENT – GENERAL INFORMATION

LT COL TIM GILBERT

SO1 TEN TORS

THE EVENT

CAMP PLAN

JC & GC
Start

JC Finish

TTC Start

Registration
(Pinfo)

Okehampton Camp Map

- 47 - Cookhouse
- 53 - Reception
- 57 - HQ DARTA
- 78 - Chaplaincy & Welfare Hub
- 83 - TTC Brief, Registration & Pinfo
- 97 - Officers' Mess
- 112 - Tribar
- 116 - Media
- 130 - CM
- 136 - MSG Ops room
- 136 - TT Ops room
- 146 - TTC/JC Registration etc
- 151 - Medical Centre
- 169 - JC Control etc

Jubilee
Challenge
Start

Ten Tors
Challenge
Campsite

Ten Tors Challenge Start Anthony Stile

Helicopter
Landing Site

Enablers
Car Park
P2

Moor Gate

Parade Square

Team Minibus

Camp Gate

Jubilee
Challenge
Campsite

Disabled and
Jubilee Challenge
Car Park

Camper Vans

Overflow
Car Park

Spectators &
TTC Vehicle
Car Park

Okehampton
Apex
Traffic
Control

To Car Park

- JC and Disabled Parking
- TTC/JC+ Withdrawal Coordination Centre
- JC Control & TTC/JC/JC+ Withdrawal Coordination Centre
- Traffic Direction

- JC Finish
- TTC Start
- TTC & JC+ Finish
- Tribar & Catering
- Controlled Parking

- Fire Muster Point
- Fire Appliances
- Fire Breaks
- TTC Brief, Registration & Public Info
- First Aid

- Reception
- QM
- VIP Parking
- Enablers Car Park
- TTC & Spectators Parking
- Engagement Village (Fri & Sat)

THE EVENT

TEN TORS CHALLENGE & GC FINISH

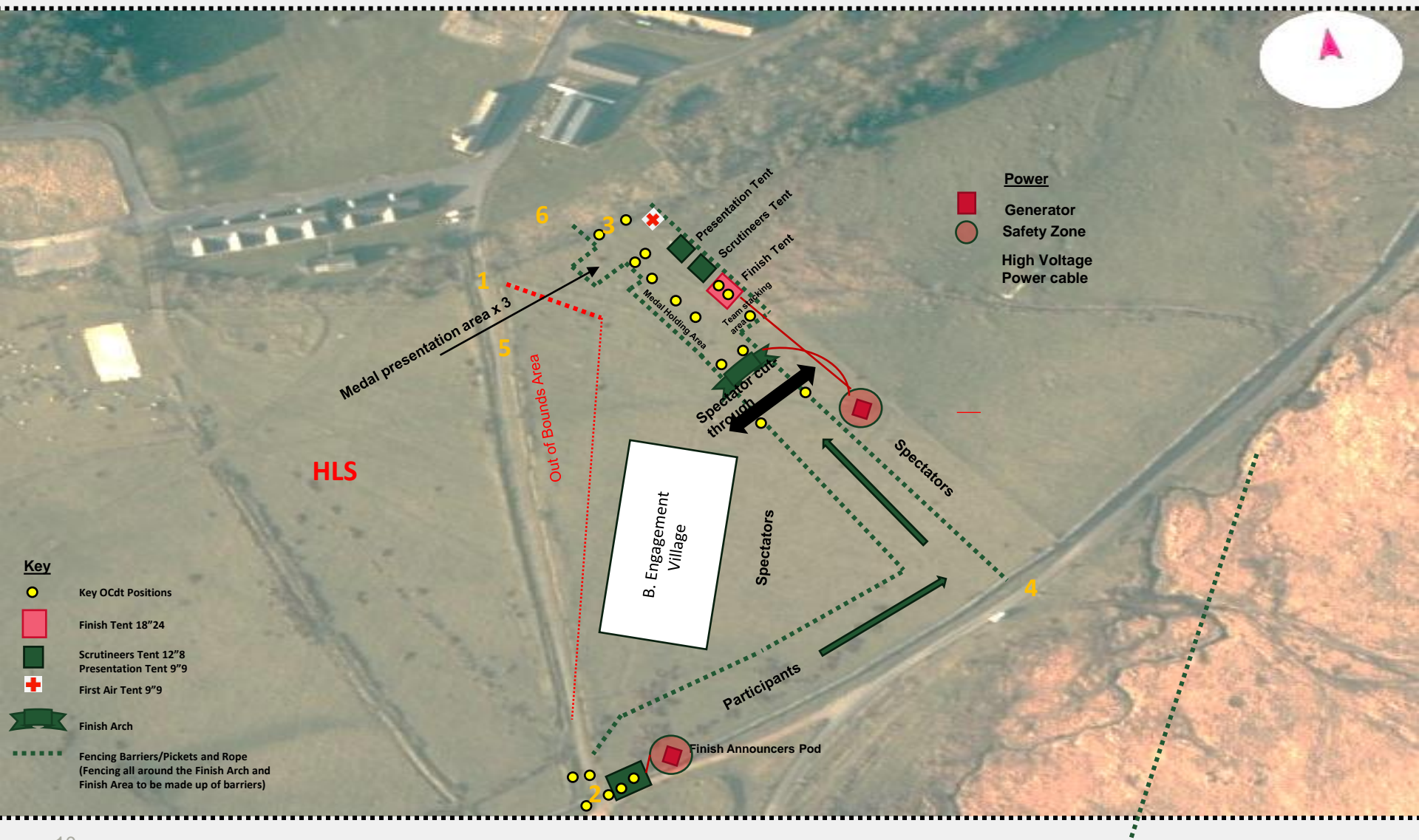

THE EVENT

TTC LOCATIONS

17 Safety Controls (SC)

- 13 support staff
- Medical post
- Road access
- All JC locations are SCs
- Will accept IVW

12 Basic Controls (BC)

- 4 support staff
- No road access
- Limited resources
- Cannot accept IVW

9 first controls

PREWLEY MOOR Sat AM
only

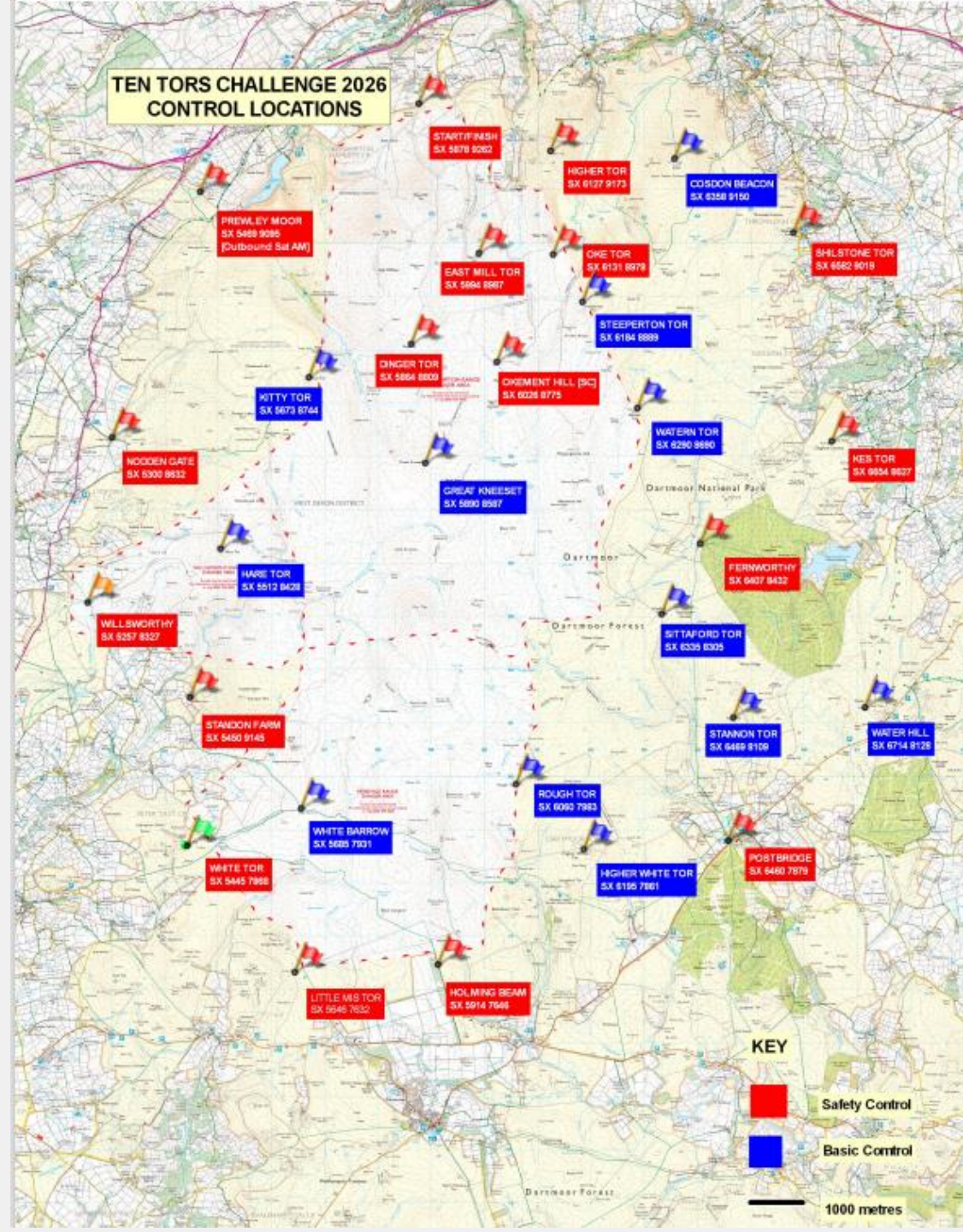

KEY EVENT TIMINGS

Date / Time	Event	Remarks
D-1 8 th May 0900 -1700 TTC 1100 -1800 JC/JC+	Teams register in PInfo	Please refer to camp layout to find it if needed.
1030	Engagement activities	
D Day 9 th May 0645	TTC participants in place	Speech, guns, parachutists, etc
0700	TTC starts	No running!!!
0730	JC/GC starts	
1800	JC ends	
2000	35 Milers & GC camp	
2200	45 & 55 Milers camp	
D+1 10 th May 0600	SC and BC open	
0800	GC depart camp	
1100	GC ends	
1700	TTC ends	

TEN TORS 2026 PINK CARD RULES FOR PARTICIPANTS

These Rules must be carried by the Team / Walking Leader and Deputy and followed by all participants. Ignoring them may disqualify your Team or Establishment from this or future Ten Tors.

Final details for the Pink Card will be updated and published by 1 May 2026.
The draft is available on the website.

TEN TORS 2026 PINK CARD RULES FOR PARTICIPANTS

Includes:

Emergency procedures

- If you are lost:
- If you have a casualty

Moorland hazards:

- Water crossings.
- Unexploded Ordnance.
- Adders.
- Ticks.
- Thunderstorms.

TEN TORS 2026 PINK CARD RULES FOR PARTICIPANTS

Cold Injury (Hypothermia).

- Extreme cold, violent shivering, stiffness, tiredness, increased heart rate and irrational behaviour.
- Stop, get under cover, replace wet clothing, rewarm slowly, add extra layers, give warm sweet drink or energy food; do not try to warm by rubbing limbs.

Non-freezing cold injury.

- Hands and feet suffer pins and needles and / or feel numb.
- Dry hands and feet, change socks and gloves, use foot powder, wriggle limbs and exercise.

Freezing cold injury.

- Cold, painful, tingling followed by numbness (including if moved) and mottled white and pink skin.
- Get into shelter; do not re-warm.

Heat illness (Hyperthermia).

- Nausea, vomiting, cramps, disturbed vision, agitation, dizziness and confusion.
- Stop, lie casualty in the shade, remove appropriate layers of clothing, and apply wet cloth to limbs and head. If conscious give water and elevate feet; if unconscious place in the recovery position.

In all cases of climatic injury request assistance immediately and be aware that others are also likely to be at risk.

N.B. Water self-replenishment and purification is the team's responsibility.

THE EVENT

RIVER CROSSING / ROAD CROSSING / OOBS AREAS

- Annex A (as per issued mapping).
- OOB Rivers & Roads are for the Event ONLY. However, in trg, all TMs to make sure participants are aware of the crossings state systems.
- Monitoring the routes walked by the Ten Tors Challenge teams helps the Organisers to check on safety and environmental compliance; eg monitor river crossings, teams risking road traffic collisions (by walking on unauthorised public roads), entry into Rare Bird Nesting Areas (RBNA), trespass on non-access land.



















Out Of Bounds Areas:

- Metalled roads and an area 200m either side unless designated as in bounds.
- Rivers (as per the River State) and Out Of Bounds Areas as shown on Annex A to the Rules – ROUTES/CROSSING POINTS MUST BE ADHERED TO - DISTANCES ARE CALCULATED BASED ON THIS.

THE EVENT

RIVER STATE INFORMATION

- Previous river state system was difficult to brief and understand, therefore added unnecessary risks.
- No change to River and crossing point data, but notation on the map has changed significantly.
- Forget the previous system; it will make it easier to understand the new system.
- **Do not use old mapping**; it will cause potentially dangerous confusion.

RIVER STATE TABLES (EVENT ONLY)					
RIVER STATE - NORMAL					
stretch 	crossing 	stretch 	crossing 	stretch 	crossing 
X	✓	✓	✓	✓	✓
RIVER STATE - HIGH					
stretch 	crossing 	stretch 	crossing 	stretch 	crossing 
X	X	X	✓	✓	✓
RIVER STATE - VERY HIGH					
stretch 	crossing 	stretch 	crossing 	stretch 	crossing 
X	X	X	X	X	✓

THE EVENT

RIVER STATES EXPLAINED

THE RIVER STATE DIRECTS WHICH
RIVER STRETCHES AND
CROSSINGS ARE UNSAFE AND
THEREFORE OUT-OF-BOUNDS
DURING THE EVENT

Very High

High

Normal

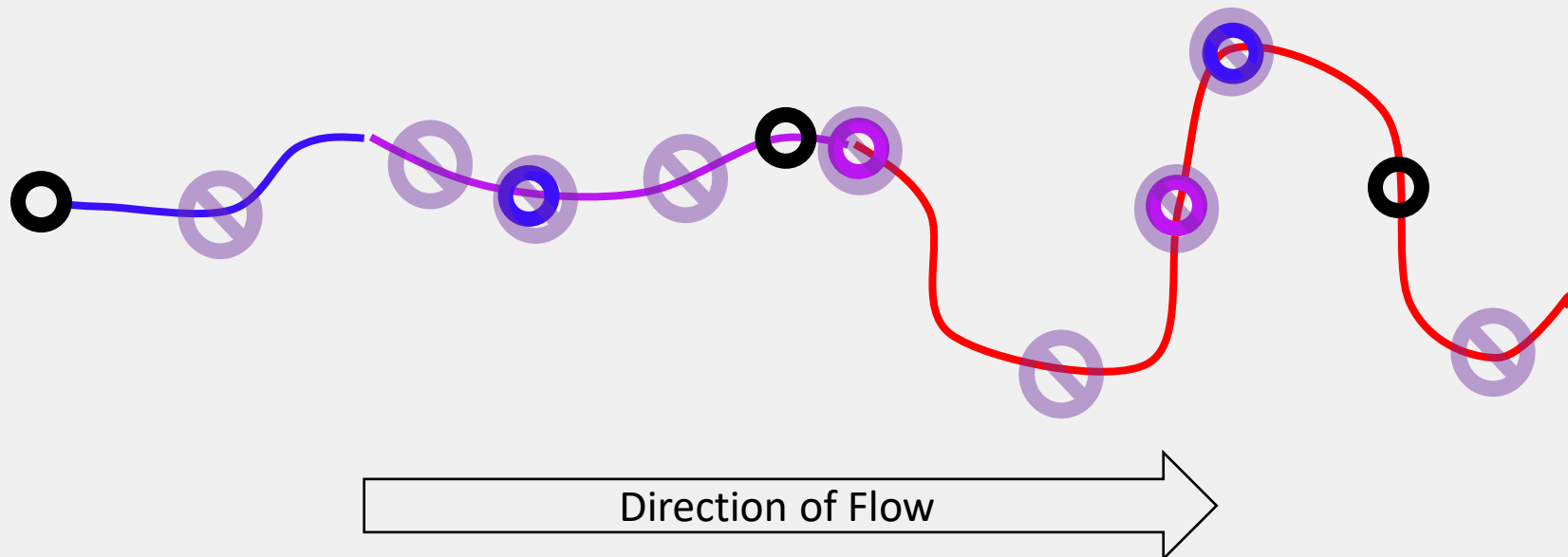

TEN TORS 2026 ORANGE CARD RULES FOR TEAM STAFF

Ignoring these Rules may disqualify your Team or Establishment from this or future Ten Tors.

Final details for the Orange Card will be updated and published by **1 May 2026**.
The draft is available on the website.

TEN TORS 2026 ORANGE CARD RULES FOR TEAM STAFF

Team Managers (TMs) and Staff are responsible for:

- The **conduct and wellbeing of participants**:
 - From arrival at Okehampton Camp until the start of the Challenge. From handover at the Finish or withdrawal system until departure from Okehampton Camp.
- The **conduct and safety** of all involved with a Team including **supporters**.
- Ensuring that all those in the campsites, including visitors, are properly briefed. Visitors entering will receive basic safety information in the brochure issued to all drivers in the carparks.
- Issuing the Notice to Parents and Guardians and **acting as the link between them and the Organisers**.

TEN TORS 2026 ORANGE CARD RULES FOR TEAM STAFF

Fire.

- Keep all designated routes in campsites clear and make sure that everyone knows where they are.
- Identify walkways to the designated main routes and liaise with neighbours to keep them clear.
- Minimise the number of gas and fuel containers in the campsites; spares are to be kept in the carparks.
- There must be at least 6m between any tent or camper van used for cooking and any other structure.
- Smoking is only allowed in designated areas; open fires (e.g. wood burners and BBQs) are forbidden.
- Establishments are to provide appropriate fire extinguishers.
- Generators are not permitted on the campsites so that emergency announcements can be heard.
- If there is a fire raise the alarm by shouting FIRE, FIRE, FIRE, call 01837 657267 and 999 and muster on the Parade Square
- TMs are to report missing persons to a PINFO.

TEN TORS 2026 ORANGE CARD RULES FOR TEAM STAFF

Medical Assistance.

- St John Ambulance have mobile medical staff across Okehampton Camp during the Event that can be tasked by calling mobile number: (TBC two weeks from Event date)
- First Aid Posts are established across Okehampton Camp.

Vehicles.

- Drivers are to follow the directions of Traffic Marshals, use the one-way circuit and comply with the traffic circuit speed limit of 15 mph.
- Unloading and loading is only permitted in designated areas; Jubilee Challenge vehicles will only be allowed to enter the campsite in exceptional circumstances.
- Vehicles are to be parked in designated parking areas as directed. Vehicles that are illegally parked or causing an obstruction may be towed away or receive a fixed penalty notice from the Police.
- There will be NO vehicle exit from Okehampton Camp on Sat 0600-0700hrs. All traffic leaving Camp will be directed onto the A30 westbound slip road from 0500 Saturday until endex.
- Camper vans are only allowed in designated parts of the carpark; caravans are not permitted.
- Please inform spectators – first aid and likely traffic situation

TEN TORS 2026 ORANGE CARD RULES FOR TEAM STAFF

Environmental Protection.

- Use the litter and toilet facilities provided and report any problems immediately.
- Showers are available for adult Team Staff only on Sat 1000 – 1400hrs in Building 91.
- Do not climb over fences or rest kit on them – use the gateways provided.

General safety.

- Teams or advance parties are not permitted to enter the campsites before Thu 0630hrs. Participants are not allowed to sleep within the campsite until 0900hrs on Fri.
- Establishments are to set up their own base within a campsite at Okehampton Camp; water, toilets, recycling and some catering is available, but otherwise Establishments must be self-sufficient. Please be considerate of others when choosing where to camp.
- Dogs must be kept on a lead, may only transit the campsite, and must not stay overnight in car parks.
- Flying drones is strictly forbidden due to the serious safety risks they pose to helicopters. Please tell spectators.
- TMs are to ensure that alcohol is consumed in a responsible manner; one member of staff must be able to take Safeguarding responsibility for their team at any point. Use What 3 Words for location within campsite.
- Keep campsite noise to a minimum from Fri 2200 – Sat 0500hrs and Sat 2200 – Sun 0700hrs.

TEN TORS 2026 ORANGE CARD RULES FOR TEAM STAFF

Registration.

- Route allocation will be published on the TT website at 0900hrs on the Tue before the Event.
- TM + 1 Participant per team, report to Registration on Fri **0900 – 1700hrs to:**
 - Confirm that team composition and critical information is correctly recorded.
 - Complete and hand in the Campsite record (**What3Words for TT26**).
 - Media consent forms (**online via the dashboard**).
 - Collect wristbands, x2 rubbish bags, Safety Beacon, opaque bag for mobile phone and a TT Map (if required).
 - Add the river state to Control Cards.
 - Receive Participant Beacon training



Post Registration.

- Individuals are to be securely fitted with their personal ID wrist bands.
- TMs are to check maps are marked with **all** staffed locations supporting the JC, GC or TTC and all the detail contained in Annex A and Annex B to the Rules.
- TMs are to check teams' proposed routes for suitability and compliance with the rules

TEN TORS 2026 ORANGE CARD RULES FOR TEAM STAFF

Safeguarding.

- The TM or Deputy TM member with photo ID, is to accompany participants to their start point by 0645 / 0715hrs.
- Either the TM or Deputy TM is to be contactable in Okehampton Camp and able to accept safeguarding responsibility at all times during the Event until all participants have been signed back.
- Participants (whether VW or DW, casualties or successful finishers) will only be signed back to the TM or Deputy TM with appropriate photo ID. In the event of hospitalisation responsibility will be handed over to the hospital and the TM or Deputy TM will be informed.
- If a participant has not been returned to the TM by Sat 1800 (JC) / Sun 1700hrs (TTC/GC) they must report this to the Withdrawal Coordination Centre to ascertain their location.

Conduct.

- Supporters and Staff must not interfere with the smooth running of the Challenge or compromise the unsupported aspect except within 500m of the start and finish where they may encourage and enthuse.

Post event.

- TMs are to inform the Organisers of any incident that occurs as a result of Ten Tors as detailed in the Rules.

TEN TORS 2026 ORANGE CARD RULES FOR TEAM STAFF

Additional Rules for the Ten Tors Challenge.

Extraction Contingency.

To support contingency plans for extracting large numbers of participants off the moor from Sat 0700hrs until the Establishment's final departure from Okehampton Camp, any Establishment with more than one team in the TTC is required to:

- Designate a road legal minibus which is to:
 - Be insured to transport participants from any Establishment.
 - Remain parked as directed in Okehampton Camp.
- Ensure a qualified and DBS-checked adult is fit and available to drive at one hour's notice.
- Plan for both to be deployed across Dartmoor in support of the Event at the cost of the Establishment.

TMs Update. The Team Managers' Update on Sat 1800hrs will include critical safety information for the following day and thus attendance from at least one member of Staff per Team is mandatory.



THE EVENT – DARTMOOR GRANITE CHALLENGE

LT COL TIM GILBERT

THE EVENT

DARTMOOR GRANITE CHALLENGE (GC)

- This Challenge is aimed at young adults with SEND^[1] (i.e. SEMH, ASD, SpLD, etc.) who would find the Jubilee Challenge too easy, but the Ten Tors Challenge inaccessible due to their respective SEND. It provides an appropriately arduous Challenge across difficult terrain and in very changeable weather over at least 18kms, including an overnight camp.

^[1] Special Educational Needs and Disability (SEND), Social, Emotional and Mental Health (SEMH), Autism Spectrum Disorder (ASM), Specific Learning Difficulties (SpLD)

- Individual / Team event (max of 4 in a team, plus accompanying adults)
- 1 Route
- Sat 0730 – Sun 1100

DARTMOOR GRANITE CHALLENGE (GC)

45 participants GC

- Now firmly established
- Individual / Team event (Max 4 in team)
- 1 Route
- Supported overnight Camping – Cullever Steps
- Cannot depart campsite before 0800hrs on Sun
- Sat 0730 – Sun 1100

THE EVENT

DARTMOOR GRANITE CHALLENGE CONTROLS

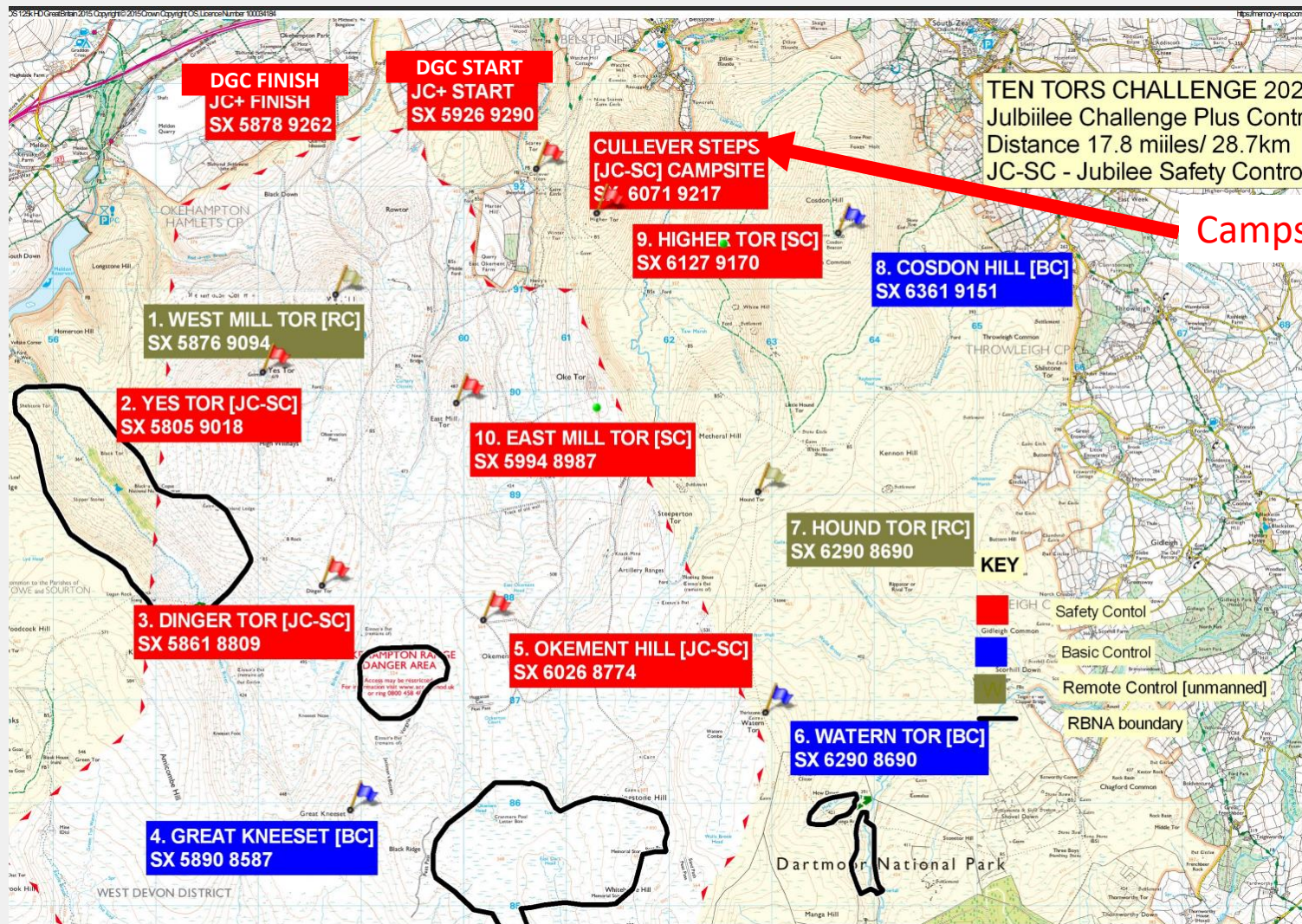

- **TMs please stay behind afterwards so we can meet you and answer any specific questions.**



JUBILEE CHALLENGE

MAJ PAUL MCDUGALL
SOUTHWEST OFFICER TRAINING REGIMENT

TEN TORS

JUBILEE CHALLENGE 2026



JUBILEE CHALLENGE 2026

- **Jubilee Challenge 2026**
- **One day event – no overnight**
- **Four Testing Routes**

One – 7.8 Miles

Two – 8.7 Miles

Three – 11 Miles

Four – 15 Miles



- **Finish in Camp Saturday 0930hrs – 1730hrs**

JUBILEE CHALLENGE 2026

- **Registration** – On line and with Ten Tors
- **Camping** – Sports Field with marked Pitches.
- **Pre Event** – c1900hrs D-1 (Fri) Confirmatory Brief – **Do you want it?**
- **Start/Finish** – No Changes D+30min (0730hrs) to NLT 1800hrs
- **Control Points** – No Changes 2 OCdts minimum on each.
- **Challengers Released to Team managers** – Off the Moor Certificate & Release point at Finish



TEN TORS

JUBILEE CHALLENGE 2026



Paul.mcdougall339@mod.gov.uk



SAFEGUARDING

SO1 TIM GILBERT
ON BEHALF OF NATHAN DITTON
DESIGNATED SAFEGUARDING LEAD

Safeguarding is Everyone's Responsibility

- **Policy.** Available on TT Website, it essential that this is read and understood.
- **Roles.** TT provide personnel from Army Cadet Safeguarding Hub to deliver event Safeguarding leadership, BUT it is essential that TMs partner.
- **TMs.** Must ensure adults are trained, prepared, deploy and able to support TT safeguarding team throughout and are able to take safeguarding lead following weekend.
- **Reporting.** Safeguarding Reports can be submitted via form in TT Safeguarding Policy, BUT TT Safeguarding leads will respond to any issues identified through TT Ops Room. Then link at earliest opportunity with relevant team's Safeguarding Lead.

Safeguarding is Everyone's Responsibility

- **Safeguarding Timeline.** TMs lead safeguarding responsibility until start day. Military Safeguarding team take leadership during event BUT must be supported by TMs.
- **Information Sharing/Communication.** It is essential that proactive information sharing occurs. TT Safeguarding team should be made aware of any potential safeguarding issues re participants prior to and during event.
- **Post Event.** TT Safeguarding Team will report incidents to participant organisations, Designated Safeguarding Leads (DSL) and if required statutory authorities.

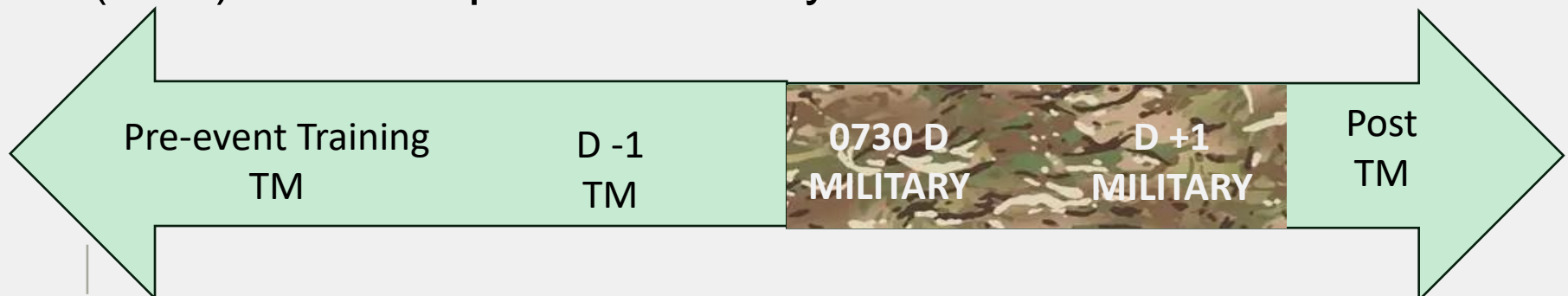

TRAFFIC MANAGEMENT

OUTLINE PLAN

- Traffic TT25 result of success of event
- Event company
 - Military personnel
 - Support from D&C 4x4
 - ANPR (VRN accuracy)
 - No pass – no parking
 - Display your pass early



- Vehicle passes
 - Main field 3050
 - Overflow 395
 - Total:
- Max vehicle passes 3445

- 1 vehicle pass per team (support vehicle arrive Thur)
- 1 vehicle pass per participant *additional cost - price tbc (if not required – don't use)*
- *All encouraged to car share where possible.*
- Every participant issued a unique link for vehicle payment via Team Manager prior to event
- Cutoff date for using link 30 April 2026
- 01 May 2026 unused vehicle passes for general sale via website

Disabled parking

- Disabled not included in numbers above
- Disabled passes purchased via website (disabled badge emailed to JCsys / TT team before being issued) *additional cost - tbc*

EVENT

AWARDS

Citation required via website



10 years



15 years



20 years

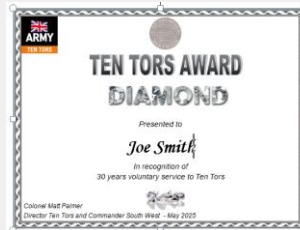

30 years



40 years



50 years



Tri Award -
meritorious

EVENT

TONY CLARK AWARD

Awarded to the person who has gone far above and beyond what is expected of them for the benefit of Ten Tors.

- This may be over one year or multiple years and should consider what the individual would be expected to do, and what they have delivered.
- The individual may be a volunteer, member of the military, contracted staff, team staff, or exceptionally a participant.
- Submission should be no more than 250 words.
- Deadline for submissions is 1st April.
- Late submissions will not be considered.
- Director Ten Tors will decide the recipient based on a short list of no more than 5 submissions.
- The shortlist will be drawn up by the Ten Tors Team.



Tony Clark Award TT26



ENGAGEMENT VILLAGE



- Tri Service and Civilian Agency Engagement Village
 - Friday 8th May 26
 - 1000 to 1800 hrs
 - Main Car Park Area
 - Sunday 10th May 26
 - 0900 to 1700 hrs
 - Finish Area
- Opportunity for Participants, Team Managers and Spectators to meet serving Military personnel
 - Get hands on with Military vehicles and equipment
 - Be entertained by the very talented British Army Engagement Ensemble
 - Find out about supporting agencies

EVENT

SOCIAL MEDIA

Please share your stories:
@armytentors



Army Ten Tors



<https://www.instagram.com/armytentors/?hl=en>



© Adrian Colston



CONCLUSION

Q&A



CONCLUSION

CLOSE

Col Palmer

